

VETO SPRING AGITATOR

ALA • TALKKARI



15-100 m³

**ENVIRONMENTALLY
SAFE ENERGY**

FUTURE TECHNOLOGY FROM ALA-TALKKARI

Veto Spring Agitator is a robust solid fuel burning device, mainly designed for heating medium-sized and large premises. The device has an even fuel feed and it does not require uniform fuel blend quality. The spring agitator system is available as a closed fuel silo or an open silo equipped with a rotary feeder.



Options

Available in outputs from 40 to 990 kW. The device is designed to perform under the most demanding circumstances. Feed screw alternatives 125—200 mm according to output. A logic based A-T Log control centre comes as standard. A Lambda 5 control, by which the system is adjusted to achieve optimum burning efficiency, is available as optional extra. Due to the strong construction, the device's reliability of operation is top class.

Safety

Safe function is ensured by a gravity drench, a mains water drench an automated burn-back control system and the rotary feeder are designed to assure a safe function of the spring agitator. When equipped with a rotary feeder, the spring agitator is also provided with a capacitive sensor to prevent overfilling of fuel.

Veto Spring Agitator (direct feed, silo)

Designed to be installed on the side of a building. The 16—22m³ silo allows long filling intervals. The rotary feeder is not included.

Fuels

Wood chips, peat, shavings and a variety of pellets are suitable to be used as fuel. Due to its functioning principle, the spring agitator can easily discharge various fuels, from fine saw dust to sod peat, without sorting.

Versatility

Thanks to its construction, the spring agitator equipped with a rotary feeder can be flexibly installed in existing premises. No need for differences in floor levels, and the device can be structurally altered to fit the intended installation space. The feed screw function has been improved by changing the shape of the feeding pipe from round to half round, which gives more room to bigger pieces of fuel to move smoothly.

Ash bin (optional)

A perfect solution for ash handling and keeping the surroundings tidy. The ash bin is air tight and compatible with the equipment. The 800 l ash bin is easy to empty and it can be equipped with adapters for a front end loader. The large volume guarantees long emptying intervals.

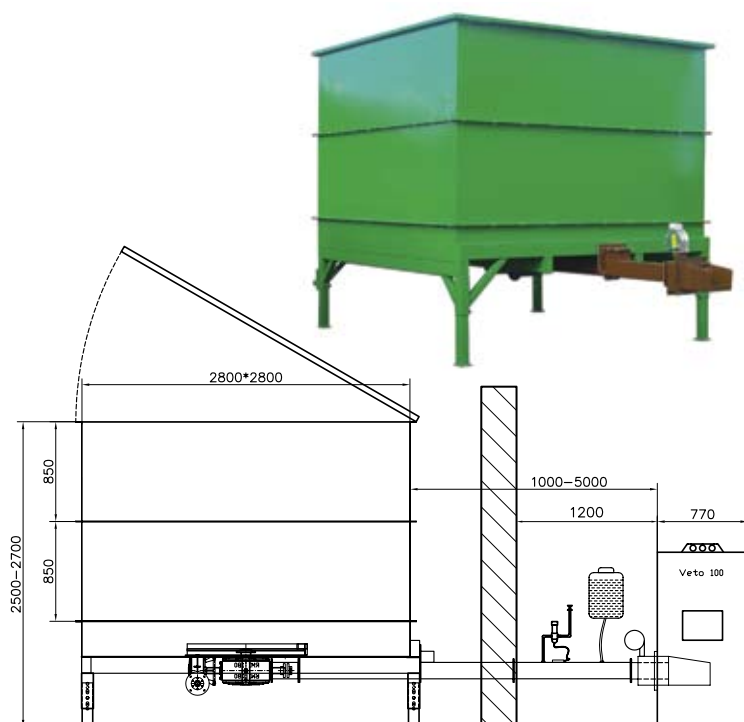

Veto Spring Agitator with silo	
Volume of silo	16-22 m ³
Type of silo	air tight
Voltage	400 V/3 phase
Logic based AT-log 1 control centre	yes
Burn-back control	triple
Fan	yes
Flame monitoring	yes
Burner output	40 - 640 kW
Number of electric motors (output)	1 x 1,5 kW
Number of feed screws	1
Capacitive sensor (rotary feeder)	no
Lambda 5 control centre	optional
Automated deashing	optional
Ash bin	optional
Extension silo 6 m ³	optional
Rotary feeder	optional
Number of springs in rotary feeder	2 pc/40 -120 kW 3 pc/160 - 360 kW 4 pc/480 - 640 kW



ROBUST AND RELIABLE BURNING DEVICE FOR VARIOUS FUEL TYPES

Veto Spring Agitator (with rotary feeder)

The height of the bottom surface of the silo may vary between 2 and 5 m. Available silo capacities 15 - 100m³. A rotary feeder is included. The equipment can be installed in existing premises.

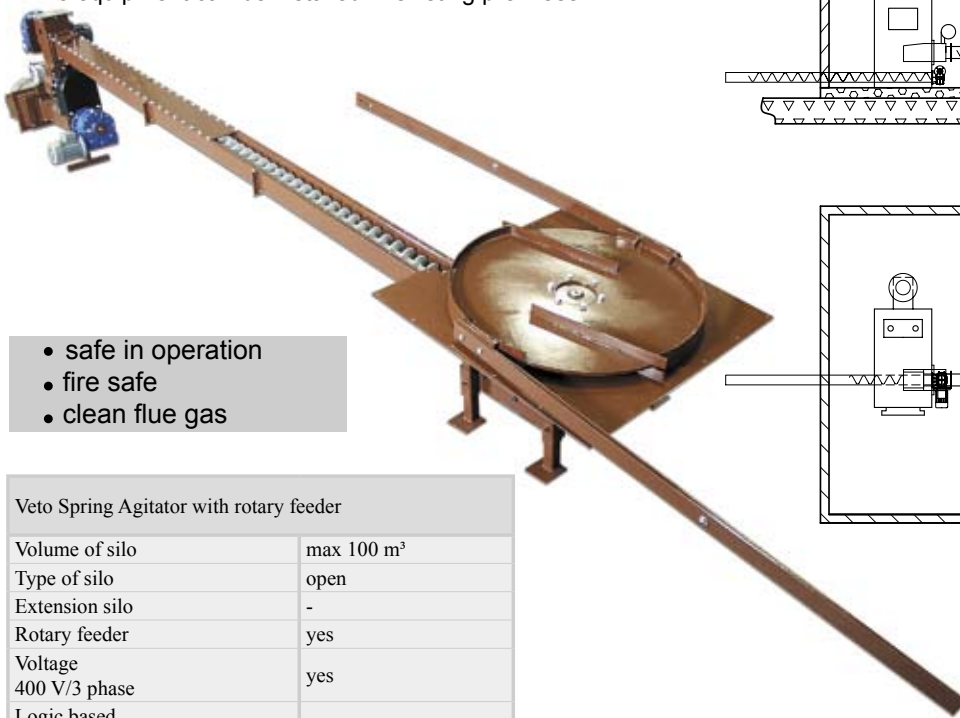
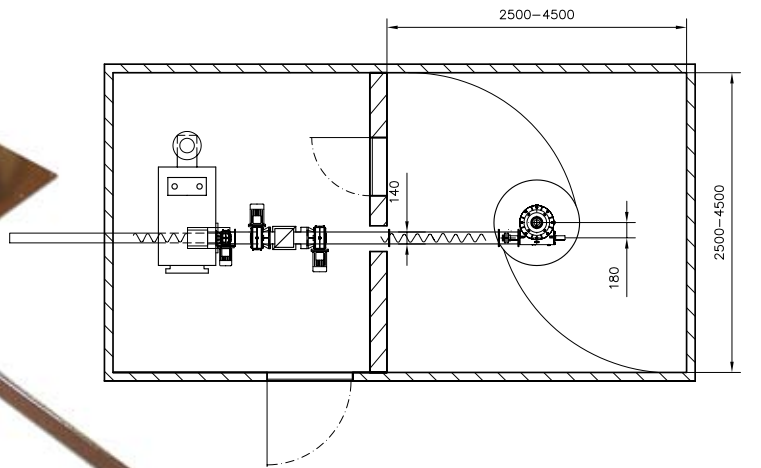
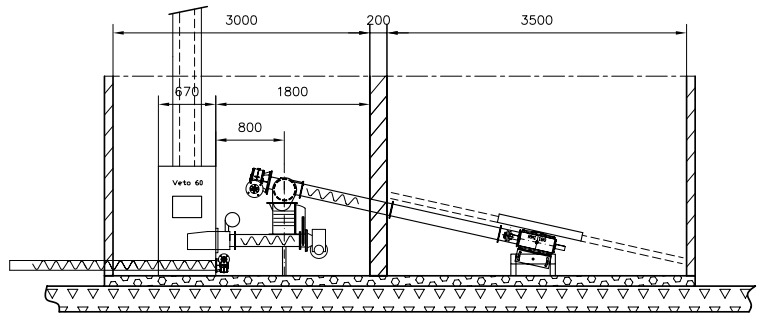

- safe in operation
- fire safe
- clean flue gas

Veto Spring Agitator with rotary feeder	
Volume of silo	max 100 m ³
Type of silo	open
Extension silo	-
Rotary feeder	yes
Voltage	yes
400 V/3 phase	
Logic based AT-log 2 control centre	yes
Burn-back control	quadruple
Fan	yes
Flame monitoring	yes
Burner output	40 - 990 kW
Number of electric motor (output)	2 x (1,1 + 1,5 kW)
Number of feed screws	2
Capacitive sensor (rotary feeder)	yes
Lambda 5 control centre	optional
Automated deashing	optional
Ash bin	optional
GSM alarm	optional
Number of springs in rotary feeder	2 pc/40 - 120 kW 3 pc/160 - 360 kW 4 pc/480 - 990 kW



Rotary Feeder

- protects the equipment against burn-back
- can be installed in various spaces, because the height and the feed direction can be selected
- prevents the air from flowing freely in and out between the silo and boiler
- prevents the flue gases from coming up into the silo

EXTRA EQUIPMENT FOR VETO SPRING AGITATOR:

102009

VETO BURNERS:

	40 kW	40 kW (mov. grt)	60 kW	80 kW	80 kW (mov. grt)	120 kW	120 kW (mov. grt)	160 kW	160 kW (mov. grt)	240 kW	240 kW (mov. grt)	360 kW	360 kW (mov. grt)	480 kW	480 kW (mov. grt)	640 kW	640 kW (mov. grt)	800 kW	800 kW (mov. grt)	990 kW	990 kW (mov. grt)	
Feed screw diameter, mm (diameter x blade thickness)	125 x 10	125 x 10	125 x 10	125 x 10	125 x 10	125 x 10	125 x 10	160 x 10	160 x 10	160 x 10	160 x 10	160 x 10	160 x 10	200 x 10	200 x 10	200 x 10	200 x 10	2 x (160 x 10)	2 x (160 x 10)	2 x (160 x 10)	2 x (160 x 10)	
Moving grate	no	yes	no	yes	yes	yes	yes	yes	yes	yes	yes	yes	yes	yes	yes	yes	yes	yes	yes	yes	yes	
Water-cooled	no	no	no	no	no	no	no	yes	yes	yes	yes	yes	yes	yes	yes	yes	yes	yes	yes	yes	yes	
Opening for burner in boiler, mm (height x width)	235 x 300	300 x 300	235 x 300	300 x 390	300 x 390	300 x 390	300 x 390	520 x 550	520 x 550	530 x 680	530 x 680	620 x 670	620 x 670	640 x 820	640 x 820	690 x 830	690 x 830	715 x 960	715 x 960	715 x 960	715 x 960	
Length of burner, mm (the part inside the boiler)	250	250	300	300	300	360	420	520	520	520	520	720	720	720	720	960	960	1000	1000	1250	1250	
Number of fans	1 x primary/secondary	1 x primary/secondary	1 x primary/secondary	1 x primary/secondary	1 x primary/secondary	1 x primary/secondary	1 x primary/secondary	1 x primary/secondary	1 x primary/secondary	1 x primary/secondary	1 x primary/secondary	1 x primary/secondary	1 x primary/secondary	1 x primary/secondary	1 x primary/secondary	1 x primary/secondary	1 x primary/secondary	1 x primary/secondary	1 x primary/secondary	1 x primary/secondary	1 x primary/secondary	1 x primary/secondary

mov. grt = moving grate



Burners

- size range 40—990 kW
- 80 kW and 120 kW burners with moving grates are air-cooled
- 160 kW and bigger burners are water cooled and equipped with primary and secondary air fans
- a moving grate discharges the fuel evenly to the burner head and removes ashes from the burner head efficiently



Two-piece ash screw

- used in burning devices with a power class of 150 kW or bigger
- the ashes fall from the burner head directly onto the ash screw
- a two-piece ash screw is suited to changing the direction of the ash flow as well as multi-level solutions



GSM alarm

- controls the function of the burning device and in case of eventual malfunction, sends an SMS to a GSM phone number
- an SMS is sent if the fire dies out, the feeding pipe overheats, motor protection relay goes off etc.
- the alarm can be programmed to be sent to several different phone numbers
- there are two different alarm centre models available



Lambda logic control

- measures the residual oxygen of flue gases and adjusts fuel feeding accordingly
- enables clean and complete burning – leaving nothing but clean ashes behind



One-piece ash screw

- keeps the combustion space clean and reduces the need for maintenance work
- the operation time is in proportion to the amount of fuel fed

Manufacturer:

ALA • TALKKARI

Veljekset Ala-Talkkari Oy
 Hellanmaantie 619
 FIN-62130 HELLANMAA
 tel: +358 6 433 6333, fax: +358 6 437 6363
 www.ala-talkkari.fi

Retailer: